

Cable output length 2m:

- Power: One shielded class 6 cable coded 1,2,3 green/yellow
- Thermal sensors: One shielded class 6 cable (2x2x0.25mm<sup>2</sup>)  
Brown-White : PTC  
Green-Yellow : KTY84
- Minimum bending radius (except for the first 50mm): See table

| Cable | Ø    | R min. |
|-------|------|--------|
| 4x1.5 | 8.6  | 103    |
| 4x2.5 | 10.8 | 130    |
| 4x4   | 12.2 | 147    |
| 4x6   | 14   | 168    |
| 4x10  | 17.6 | 211    |

ZONE FREE OF ANY PART  
(cable passing)  
NO STRESS, NO BENDING, IN THIS AREA

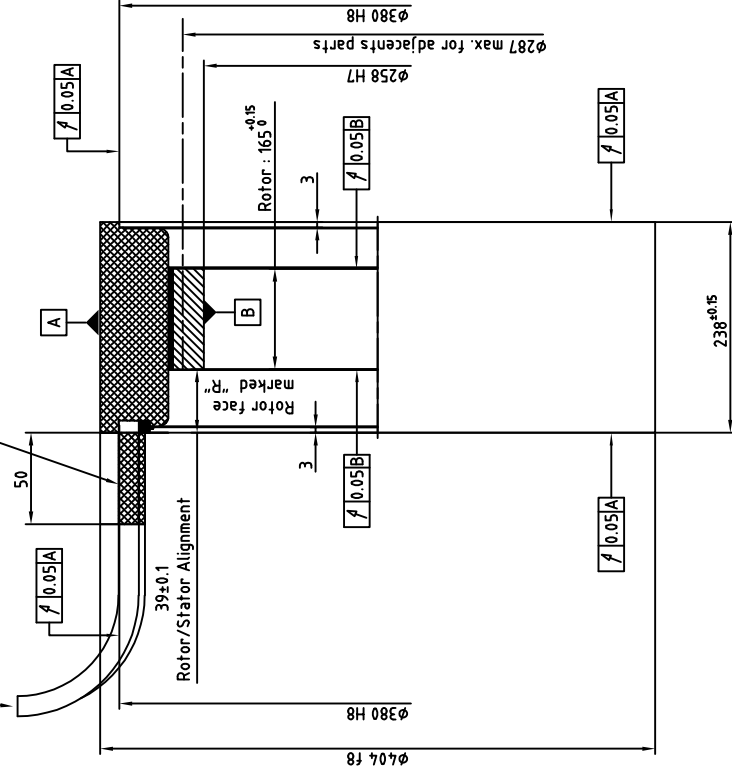

2 series of 12 equidistant holes M6  
One serie on each stator face  
Angularly aligned series

2 series of 12 equidistant holes M6  
One serie on each rotor face  
Angularly aligned series

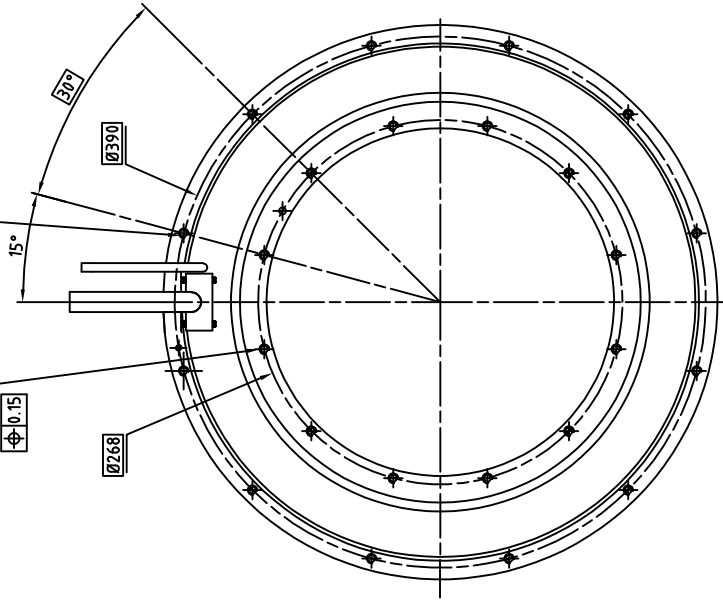

Nota:  
- This drawing is valid only for motors with nominal current lower than 53 Amps.  
- If the nominal current is greater than 53 Amps, please contact us.  
- Rotor is not fitted in the stator  
For more information about mounting see document 400STK0-WA002

**ALXION**  
AUTOMATIQUE & PRODUCTIQUE  
Parc Technologique des Fossés Jean  
92712 COLOMBEES Cedex  
Té: 014-1306304 - Fax: 014-1306136

400STK6M1XXXXXX