

Power cable diameter and section depends on rated current

- U : Phase 1
- V : Phase 2
- W : Phase 3
- Green/Yellow : Ground

Encoder + thermal sensor cable

- Us : White
- GND : Brown
- REFSIN : Green
- REFCOS : Grey
- DATA+ RS485 : Blue
- DATA- RS485 : Red
- +SIN : Yellow
- +COS : Pink
- CTP : Black
- CTP : Violet
- KTY84 : Grey/Pink
- KTY84 : Red/Blue

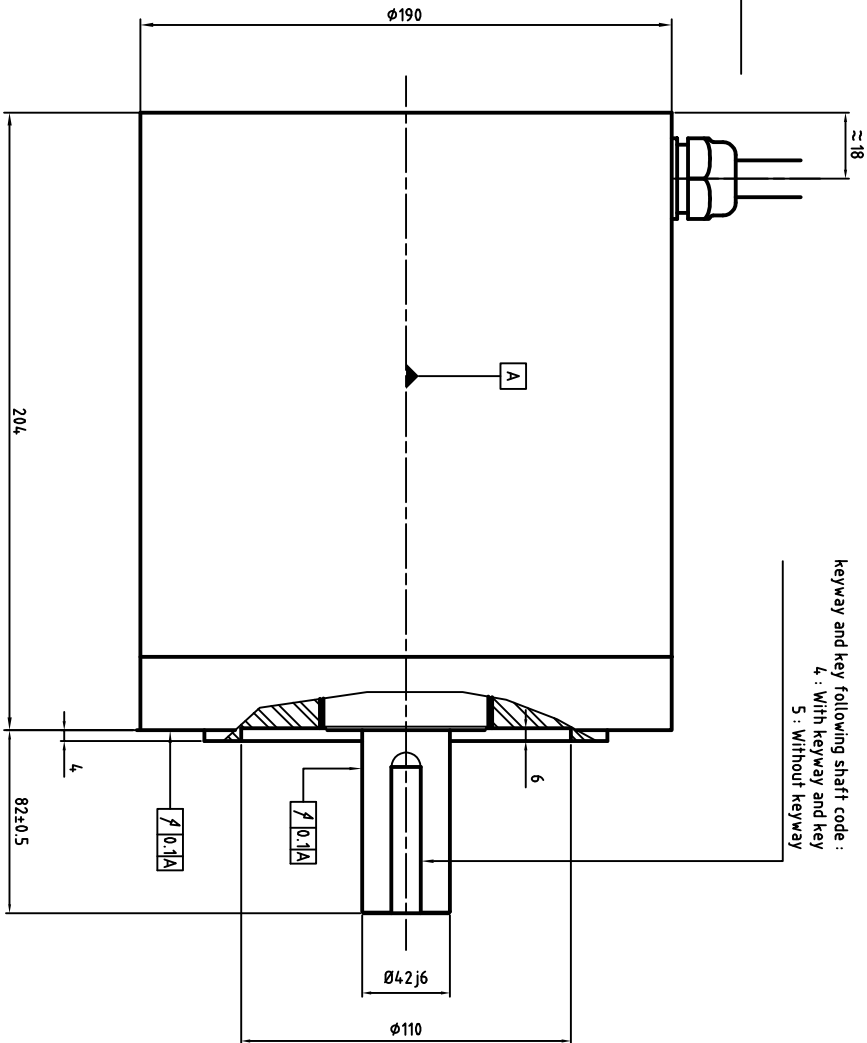

keyway and key following shaft code :
 4 : With keyway and key
 5 : Without keyway

ALXION

AUTOMATIQUE & PRODUCTIQUE
 Parc Technologique des Fossés Jean
 92712 COLONBES Cedex
 Tél: 014.1306304 - Fax: 014.1306136

190S T2M2[4-5]3BXXXXX